

**GLASSHOUSE**

THE IMPORTANT THINGS

**VENUE PROFILE**

YOU NEED TO KNOW

GLASSHOUSE

PART OF  
**THE BIG GROUP**



## GLASSHOUSE

Located on the banks of the Yarra and set in the heart of the famous Olympic Parks Precinct, Glasshouse offers a choice of magnificent event spaces to take full advantage of the stunning views across the Yarra River and surrounds.

Boasting interior design by the world renowned architects Hecker Guthrie with beautiful finishes and fixtures, the latest in audio visual technology and exceptional event management and catering by The Big Group, Glasshouse is the perfect venue for sophisticated private and corporate events.

Glasshouse accommodates cocktail parties for up to 1000 and seated events for up to 500.

It is also equipped with an operable wall that can divide the room at 150 or 350 capacity for more intimate events.



## THE EVENT SPACE

### Event Space Venue Hire

For the exclusive use of Glasshouse please allow a venue hire fee from \$3,500.00, inclusive of:

- 2 hour bump in prior to your event start time
- 1 hour bump out on conclusion of the event
- Security guards for the duration of your event
- Custom made lectern with microphone; sound system and technician on site additional charge
- 2m x 1.5m black stage
- Taupe weave or black weave linen and crisp white napkins
- Electronic seating chart
- Glass votives with tea light candles
- High bar tables and stools
- Existing décor and lounge furniture in foyer
- Cloaking facilities
- Private green room with en-suite bathroom
- 1.8m round tables and/or 1.6m x 1.2m rectangular tables
- Table centrepieces with marble basics tray

	Banquet (no dance floor)	Banquet (with dance floor)	Theatre	Cocktail	Cabaret
<b>Event Space</b> (Whole room)	500	450*	500	1000	400
<b>Event Space</b> (Larger half)	350	250*	300	700	250
<b>Event Space</b> (Smaller half)	150	110*	200	300	100
<b>Pre Event Space</b>	-	-	-	350	100
<b>Balcony</b> (Oval Side)	-	-	-	100	-

\*based on a 8m x 8m dance floor (please note, this is not included in the venue hire)



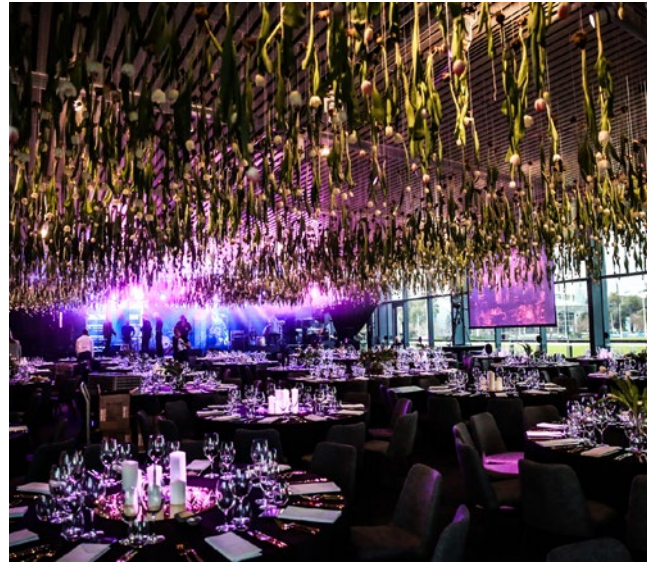

# GLASSHOUSE EVENT SPACE FLOOR PLAN

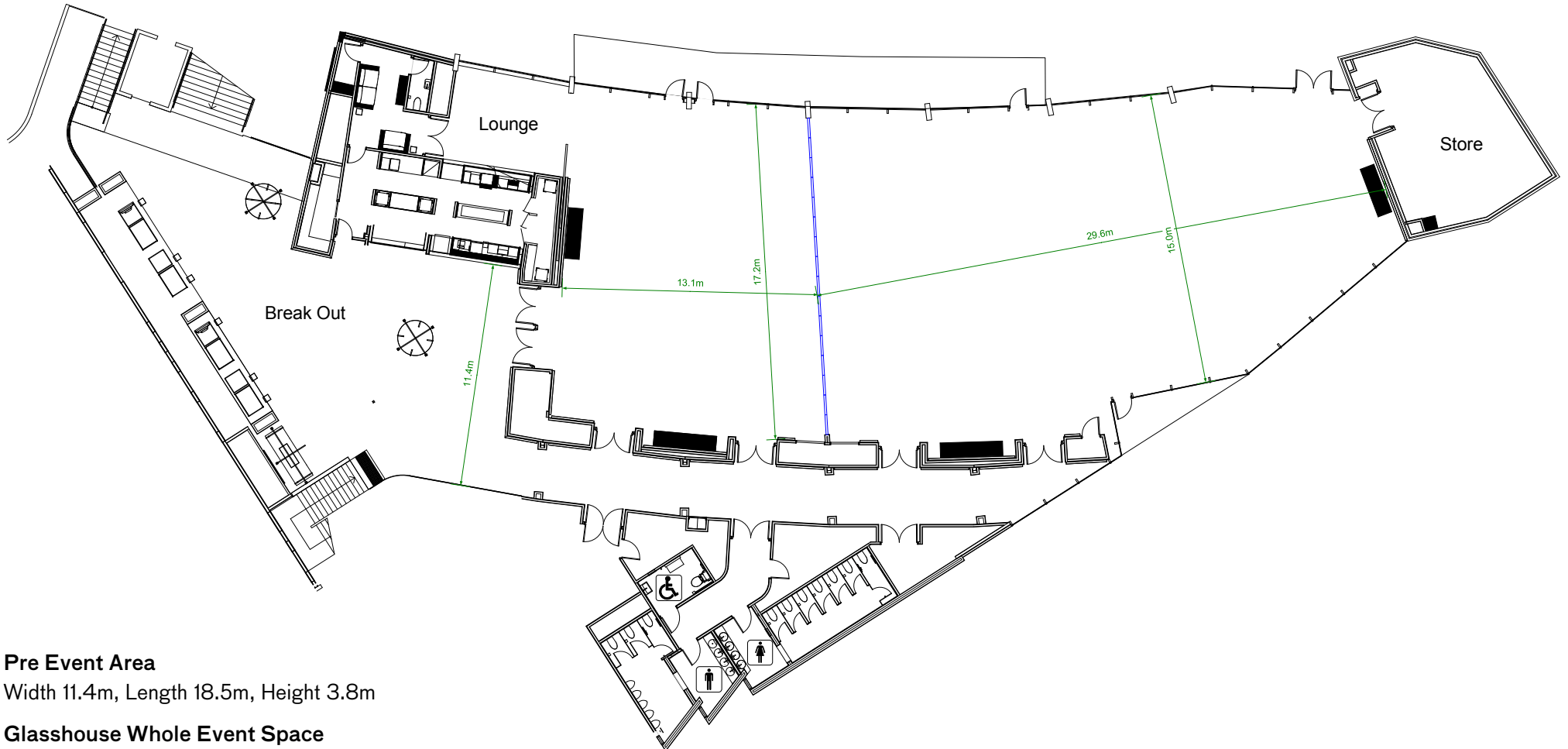

## Pre Event Area

Width 11.4m, Length 18.5m, Height 3.8m

## Glasshouse Whole Event Space

Width 17.2/15m, Length 42.7m, Height 3.8m

## Balcony

Width 2.8m, Length 35.5m, Height 5.6m





## THE EXECUTIVE LEVEL

The Executive Level comprises The Boardroom and The Executive Suite.

Our private Boardroom, caters for 18 to 24 guests, featuring luxurious leather Eames chairs, a solid oak table, inbuilt plasma screen and teleconference equipment. It also offers electronic window blinds and private balcony access with views of Melbourne's CBD and Olympic Park.

The Executive Suite is the perfect blank canvas for a range of events including meetings, intimate lunches or smaller cocktail parties. The space may be utilised as a whole, or split by the operable wall.

### Boardroom Venue Hire

Breakfast hire – \$1,000.00

Half day hire – \$1,000.00

Full day/night hire – \$2,000.00

### The Executive Suite Venue Hire

Breakfast hire – \$500.00

Half day hire – \$500.00

Full day/night hire – \$1,000.00

	Boardroom	Theatre	Cocktail	Cabaret
<b>Boardroom</b>	18-24	-	-	-
<b>Boardroom Balcony</b>	-	-	15	-
<b>The Executive Suite - Room 1</b> <i>(operable wall in place)</i>	14	-	30	-
<b>The Executive Suite - Room 2</b> <i>(operable wall in place)</i>	8	-	-	-
<b>Executive Suite</b> <i>(whole room)</i>	32	40	70	18



## THEATRE

The Glasshouse Theatre offers state of the art facilities, accommodating 152 guests in comfortable seating with swivel trays. Features include in-house projector, large screen, surround sound, custom built lectern with microphone and control panel. Overhead microphones may be lowered to allow recording of the session.

### Theatre Venue Hire

For the exclusive use of the theatre please allow a venue hire fee from:

Half day hire – \$1,000.00

Full day/night hire – \$2,000.00

	Boardroom	Theatre	Cocktail	Cabaret
<b>Theatre</b>	-	152	-	-
<b>Theatre Foyer</b>	-	-	152	-





## THE EATERY

The Glasshouse Eatery is the perfect spot for a more relaxed occasion. With its abundance of natural light, modern blond timber furnishings, sleek tiled flooring and expansive outdoor deck, this indoor/outdoor space provides guests with 180 degree panoramic views of Melbourne's Olympic Precinct. The Eatery is available from 5.00pm on weekday evenings, and anytime on the weekend.

### The Eatery Venue Hire

For the exclusive use of The Glasshouse Eatery please allow a venue hire fee from \$1,000.00 inclusive of:

- Security guard for the duration of your event
- Sound system and microphone
- High bar tables and stools
- Existing décor
- Cloaking facilities

	Banquet	Theatre	Cocktail	Cabaret
<b>The Eatery</b>	-	-	145	-
<b>Eatery Outside</b> <i>(Subject to weather)</i>	-	-	145	-



### **AV, Sounds and Lighting**

Harry the Hirer are our preferred in-house audio visual supplier at Glasshouse delivering superior audio visual services, technology and coordination solutions to our client's for their events.

An audio visual technician will be required during your event to manage the in house equipment. Technician charges are from \$85.00 per hour, with a minimum 4-hour booking.

We encourage you to speak directly with an experienced member of HTH productions regarding options for audio visual or lighting solutions to enhance your event. Please feel welcome to contact Emma Rogers on 03 9425 8666 or [emmar@harrythehirer.com.au](mailto:emmar@harrythehirer.com.au)

### **Dance Floor – quotation upon request**

We work with numerous dance floor suppliers and would be happy to arrange a quotation on your behalf.

### **Parking**

Please speak to our Event Managers regarding parking options.

The Eastern Plaza Carpark via entrance D on Olympic Boulevard (which is across the road from Glasshouse) is open for Public Parking. Parking is subject to space available and subject to the fee set by Melbourne & Olympic Parks. This is normally \$7.50. We strongly recommend you pre book parking to avoid disappointment. <https://prebook.mopt.vic.gov.au/https://prebook.mopt.vic.gov.au/>

Alternatively, you may prefer to use the very reasonably priced metered parking on Alexandra Avenue and make the short walk over Swan Street bridge.

## FIND US

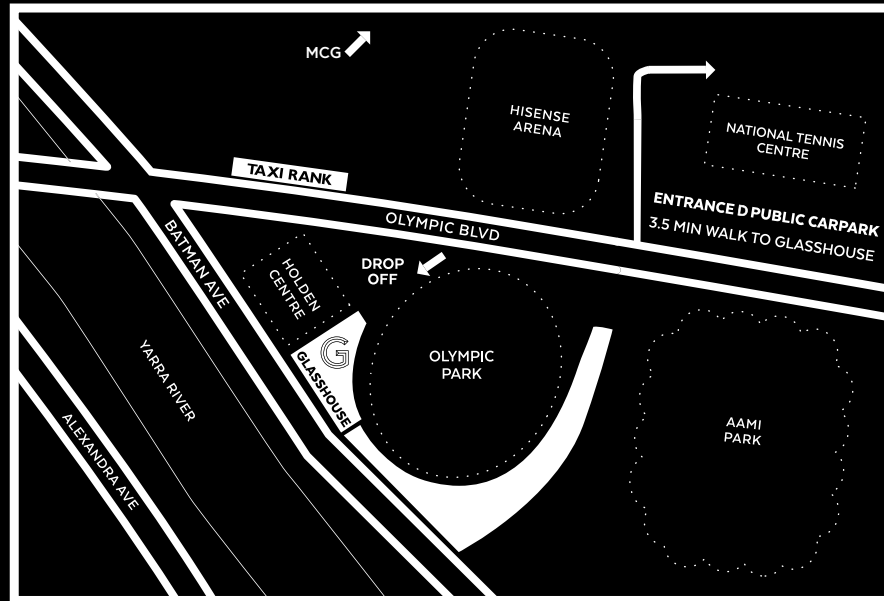

TALK TO US

T. +61 3 8416 9700

EMAIL US

[ENQUIRE@THEGLASSHOUSE.COM.AU](mailto:ENQUIRE@THEGLASSHOUSE.COM.AU)

# GLASSHOUSE

PART OF  
THE BIG GROUP